

TNC

Länge = 0,5 m
leght = 0,5 m

female
male

Liegt lose bei !
Set mounting parts

Montage der Kontakte mittels
4-Dorn Crimpzange durchführen!
*Mount the contacts using a 4-mandrel
crimping tool!*

Montage nur durch Fachkundiges Personal!
Mounting only by competent personal

Gewicht: 0 Kg
Weight: 0 Kg

Seite 1 von 2
Page 1 of 2

Montageanleitung Han Coax

Assembly instruction Han Coax

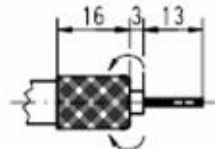
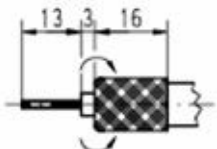
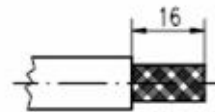
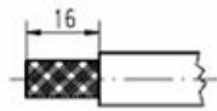

Schirmgeflecht umlegen
pull back the shielding braid

Schirmgeflecht umlegen
pull back the shielding braid

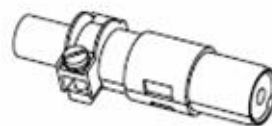
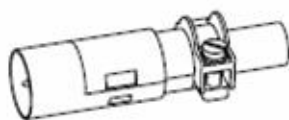
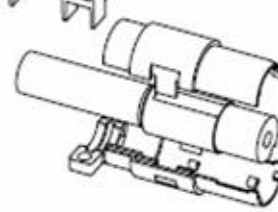
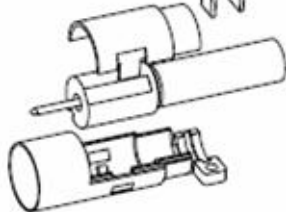
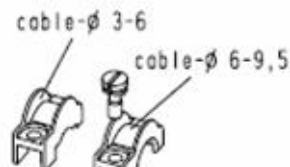
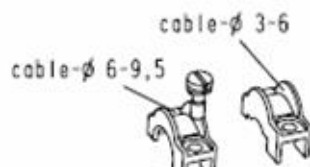

09 15 001 3013

09 15 001 3113

SK Han 1721

Loe. 12.02.03
SDT.

Alle Rechte vorbehalten. All rights reserved.

Mit freundlicher Genehmigung der Hartig AG.
With kind approval of Hartig AG.

Quelle:
HARTING AG & Co. KG
Marienwerderstr. 3
32339 Espelkamp